

**SCOPE OF WORK NOTES**

- WEED REMOVAL AND FINISH GRADING TO BE PERFORMED PRIOR TO SOD PLACEMENT.
- CONTRACTOR TO PROVIDE TWO APPLICATIONS OF HERBICIDE. TILL SOIL AND WATER AREA BETWEEN APPLICATIONS TO ALLOW POTENTIAL NEW GROWTH OF BERMUDA GRASS TO SPROUT.
- WEED REMOVAL/ABATEMENT TO BE PERFORMED UTILIZING A ROTADAIRON WITH SCREENING TINES SET TO FINISH GRADES FOR NEW SOD PLACEMENT. SCREEN SOIL TO REMOVE ROCKS AND DEBRIS GREATER THAN 1" IN DIAMETER FROM THE TOP 2" OF THE SOIL. EXISTING WEEDS AND VEGETATION TO BE TILLED TO DEPTHS OF 4'-6" UTILIZING THE ROTADAIRON.
- UPON COMPLETION OF ROUGH GRADING OPERATIONS, THE CONTRACTOR SHALL PROVIDE A SOILS REPORT PREPARED BY A QUALIFIED SOILS SPECIALIST AND SUBMIT TO THE OWNER FOR FINAL APPROVAL. SOILS SAMPLES SHALL BE COLLECTED PRIOR TO THE INSTALLATION OF SOD MATERIAL. THE FOLLOWING MINIMUM ITEMS SHALL BE INCLUDED IN THE ANALYSIS:
  - INFILTRATION RATE.
  - SOIL TEXTURE.
  - CATION EXCHANGE CAPACITY.
  - SOIL FERTILITY INCLUDING TESTS FOR NITROGEN, POTASSIUM, PHOSPHOROUS, PH, ORGANIC MATTER AND SPECIFIC CONDUCTANCE (E.C.).
  - RECOMMENDATIONS FOR SOIL PREPARATION PRIOR TO SOD PLACEMENT.
- PRIOR TO SOD PLACEMENT, SOIL AMENDMENTS SHALL BE ADDED PER RECOMMENDATIONS OF THE SOILS REPORT. THE RESULTS OF THE SOILS TESTS THE CONTRACTOR PERFORMS SHALL DETERMINE ACTUAL AMENDMENTS TO BE INSTALLED AND SHALL NOT ALTER FINAL BID TO OWNER. AMENDMENTS SHALL BE APPLIED AND TILLED INTO THE SOIL UTILIZING A ROTADAIRON WITH SCREENING TINES AND ROLLER WHEEL AND GRADING BAR TO SET FINISH GRADES FOR NEW SOD PLACEMENT.
- DO NOT PERFORM ANY ROTADAIRON OPERATIONS OVER THE FOLLOWING AREAS:
  - AREAS WHERE EXISTING TREE ROOTS ARE VISIBLE OR MAY BE PRESENT.
  - EXISTING SPRINKLERS AND VALVE BOXES.
  - OPERATIONS TO BE PERFORMED IN THESE AREAS BY UTILIZING HAND TOOLS.
- IRRIGATION SYSTEM WITH THESE AREAS IS COMPRISED OF EXISTING ROTATORS (HUNTER 1-25'S AND HUNTER 1-40'S). CONTRACTOR RESPONSIBLE FOR FLAGGING AND PROTECTING THE EXISTING ROTATORS FOR RE-USE.
- FIELD LOCATE ALL EXISTING VALVES CURRENTLY CONTROLLED WITH HUNTER NODE BATTERY POWERED CONTROLLERS. REMOVED BATTERY CONTROLLERS AND INSTALL NEW CONTROL WIRE FROM EACH VALVE TO THE EXISTING CONTROLLER.
- CONFIRM THE LOCATION OF ALL EXISTING IRRIGATION SYSTEM COMPONENTS THAT WILL REMAIN AND/OR BE ADJUSTED AS PART OF THE WORK PRIOR TO STARTING THE WORK OPERATIONS. SEE NOTE BELOW FOR ADDITIONAL INFORMATION.

**EXISTING IRRIGATION NOTE:**

THE GENERAL IRRIGATION SCOPE OF WORK INCLUDES REUSING THE EXISTING SYSTEM AND CONNECTING THE EXISTING VALVES WITHIN THE WORK LIMITS TO THE ADJACENT EXISTING IRRIGATION CONTROLLER.

CONTRACTOR RESPONSIBLE TO FIELD VERIFY EXACT LOCATION OF ALL EXISTING IRRIGATION COMPONENTS PRIOR TO STARTING THE WORK. FIELD VERIFICATION OF EXISTING ITEMS INCLUDES, BUT IS NOT LIMITED TO THE FOLLOWING ITEMS DURING THE DURATION OF THE WORK:

- SYSTEM POINT OF CONNECTION AND SHUT OFF-VALVES
- PRESSURE MAINLINE
- ROTOR SPRINKLERS
- UTILITY VALVES (GATE VALVES, QUICK COUPLERS, ETC.)
- ALL EXISTING UTILITIES
- TREE ROOTING LIMITS
- IRRIGATION CONTROLLER
- LANDSCAPE EDGE, CURBING AND HARDSCAPE LIMITS
- HARDSCAPE CROSSINGS AND WIRE CONDUIT

**EXISTING IRRIGATION CONTROLLER**

COORDINATE AND REVIEW THE EXISTING IRRIGATION AND CONTROLLER WITH DISTRICT OFFICIALS FOR A FULL UNDERSTANDING OF THE LAYOUT OF THE SYSTEM. ANY DAMAGE DONE TO THE EXISTING SYSTEM SHALL BE REPAIRED/REPLACED BY THE CONTRACTOR AT NO ADDITIONAL COST TO THE OWNER.

**SOD NOTES**

- ALL SOD SHALL BE CUT WITHIN TWENTY-FOUR (24) HOURS PRIOR TO INSTALLATION.
- CAREFULLY SMOOTH ALL SURFACES TO BE SODDED. ROLL AREA TO EXPOSE SOIL DEPRESSIONS OR SURFACE IRREGULARITIES. RE-GRADE AS REQUIRED.
- SPREAD TURF STARTER FERTILIZER ONTO THE SOIL EVENLY AT THE RATE NOTED IN THE SOILS ANALYSIS.
- LAY FIRST STRIP OF SOD ALONG A STRAIGHT LINE (USE A STRING IN IRREGULAR AREAS). BUTT JOINTS TIGHTLY, BUT DO NOT OVERLAP EDGES. ON SECOND STRIP, STAGGER JOINTS. USE A SHARP KNIFE TO CUT SOD TO FIT CURVES, EDGES AND IRRIGATION HEADS.
- DO NOT LAY WHOLE LAWN BEFORE WATERING. WHEN A CONVENIENTLY LARGE AREA HAS BEEN SODDED, WATER LIGHTLY TO PREVENT DRYING. CONTINUE TO LAY SOD AND TO WATER UNTIL INSTALLATION IS COMPLETE.
- AFTER LAYING ALL SOD, ROLL LIGHTLY TO ELIMINATE IRREGULARITIES AND TO FORM GOOD CONTACT BETWEEN SOD AND SOIL. AVOID A VERY HEAVY ROLLER OR EXCESSIVE INITIAL WATERING WHICH MAY CAUSE ROLLER MARKS.
- WATER THE COMPLETED LAWN SURFACE THOROUGHLY. SOIL SHOULD BE MOISTENED AT LEAST EIGHT (8) INCHES DEEP. REPEAT IRRIGATION AT REGULAR INTERVALS TO KEEP SOD MOIST AT ALL TIMES UNTIL ROOTED. AFTER SOD IS ESTABLISHED, DECREASE FREQUENCY AND INCREASE AMOUNT OF WATER PER APPLICATION AS NECESSARY.
- REPLACE ALL DEAD OR DYING SOD WITH EQUAL MATERIAL AS DIRECTED BY THE OWNER.
- SOD AREAS TO BE PREPARED WITH A MIN 12" AMENDED SOIL.
- IMMEDIATELY AFTER AWARD OF CONTRACT, THE CONTRACTOR SHALL NOTIFY THE LANDSCAPE ARCHITECT IF SPECIFIED PLANT MATERIAL IS AVAILABLE FROM COMMERCIAL NURSERIES. IN THE EVENT THAT A PLANT IS NOT AVAILABLE, THE CONTRACTOR SHALL PROVIDE ALTERNATE PLANT MATERIAL SELECTIONS COMPARABLE TO THE ORIGINAL SPECIFIED SPECIES. SUCH CHANGES WILL NOT ALTER THE CONTRACTOR'S ORIGINAL BID PRICE UNLESS A CREDIT IS DUE TO THE OWNER. CONTRACTOR TO SOURCE MULTIPLE NURSERIES WHEN ORDERING PLANT MATERIAL.
- CONTRACTOR RESPONSIBLE FOR EROSION AND SEDIMENT CONTROL AT ALL TIMES. EROSION AND SEDIMENT CONTROL MEASURES SHALL BE MAINTAINED UNTIL DISTURBED AREAS ARE STABILIZED. ALL EROSION AND SEDIMENT CONTROL MEASURES SHALL BE CHECKED BEFORE AND AFTER ALL STORMS TO ENSURE ALL MEASURES ARE FUNCTIONING PROPERLY.
- ALL SEDIMENT DEPOSITED ON PAVED ROADWAYS, HARDSCAPES, SIDEWALKS OR OTHER NON-PLANTER AREAS SHALL BE SWEEPED AT THE END OF EACH WORKING DAY.
- ALL EXISTING TREES TO REMAIN SHALL BE PROTECTED FROM DAMAGE AT ALL TIMES. DO NOT STORE CONSTRUCTION EQUIPMENT BELOW THE CANOPY OF ANY TREES TO REMAIN. DAMAGE TO ANY EXISTING TREES OR PLANT MATERIAL TO REMAIN SHALL BE REPLACED BACK TO ORIGINAL CONDITIONS AT NO ADDITIONAL COST TO THE OWNER.

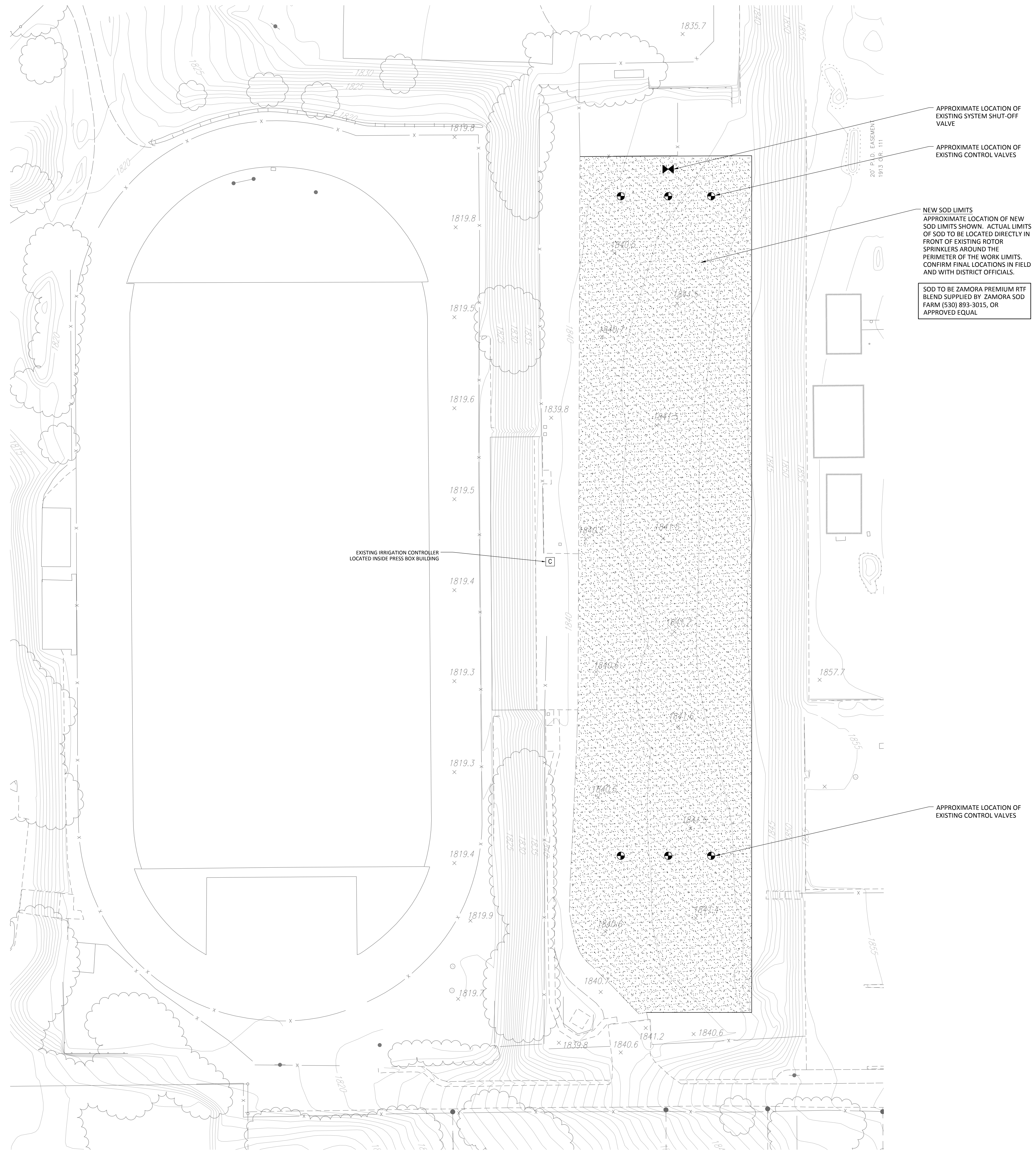

ARCHITECT	LANDSCAPE ARCHITECT

- GENERAL NOTES**
- This sheet is part of a set and is not to be used alone.
  - This sheet is not to be used for construction unless the architect's stamp and signature appear on the drawings and the status box indicated drawings have been released for construction.
  - These plans and prints thereof, as instruments of service, are owned by the architect and are for use on this project only. Reproduction and/or distribution without the prior written consent of the architect is forbidden.
  - Copyright Studio W Associates, Inc. 2021.

NO.	REMARKS	DATE

NO.	REMARKS	DATE

**KEY PLAN**

PARADISE UNIFIED SCHOOL DISTRICT

6696 CLARK ROAD  
PARADISE, CA 95969

MIDDLE FIELD SOD REPLACEMENT AT PARADISE HIGH SCHOOL

5911 MAXWELL DRIVE  
PARADISE, CA 95969

LANDSCAPE PLAN